

Communal Housing Typology On Mars

Group 4

David, Coby, Mikolaj, Simon



Workflow for conceptual design

- Update of design strategy
- Update of housing unit design
- Update of membrane structure

Case Study

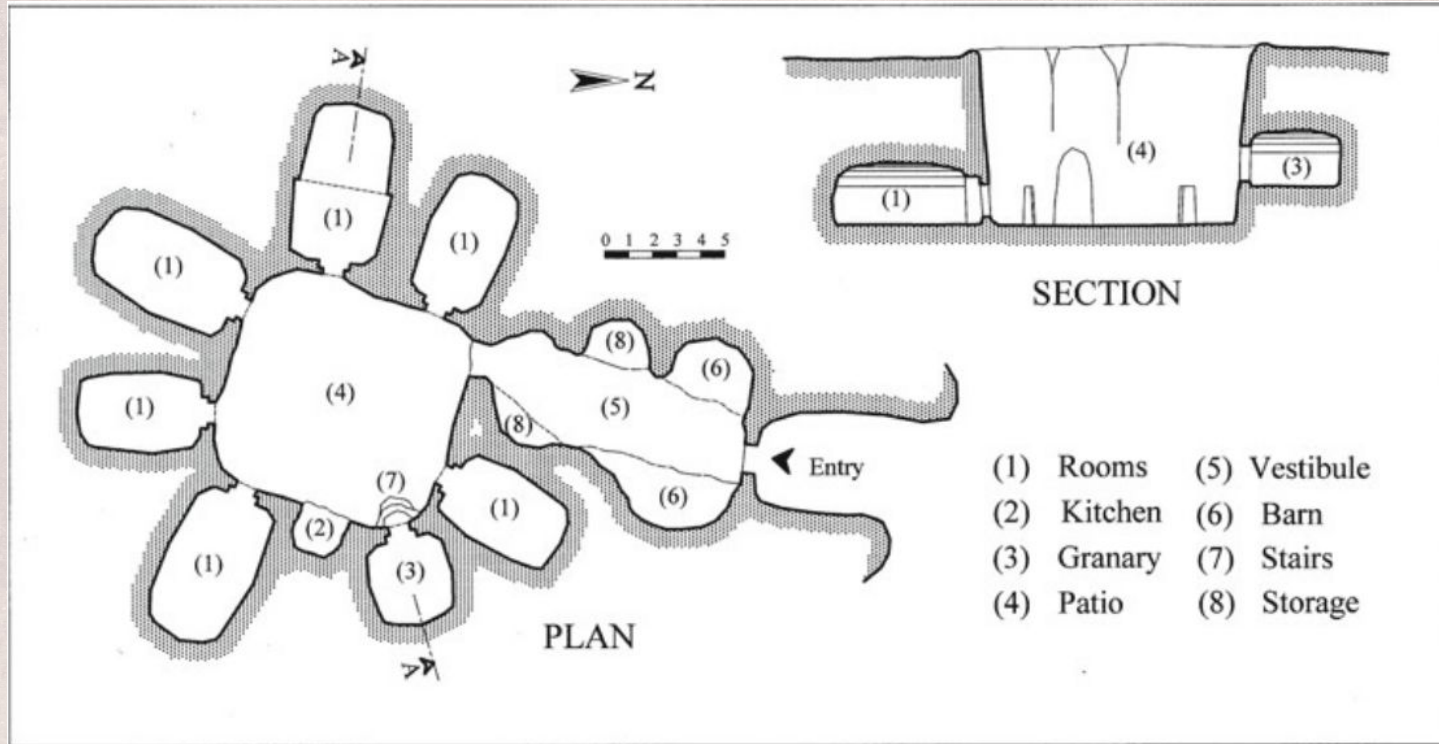

(1)

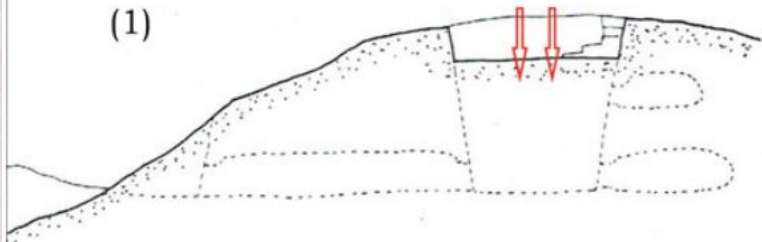

(4)

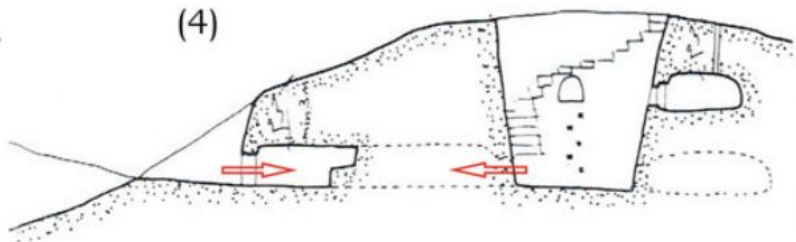

(2)

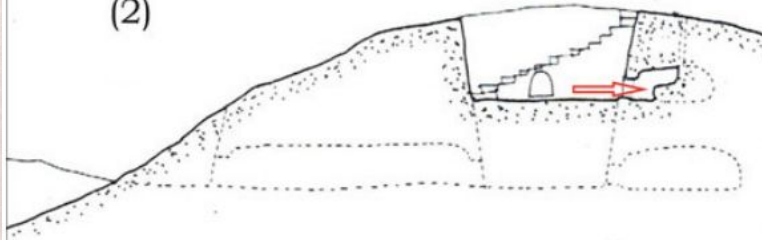

(5)

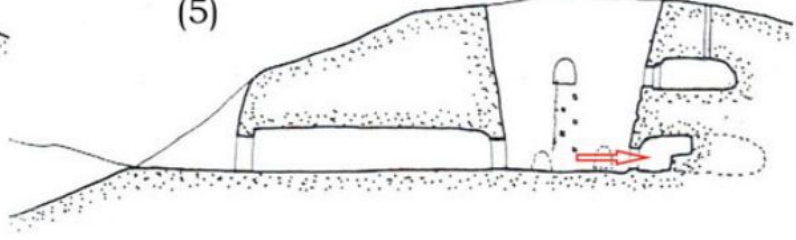

(3)

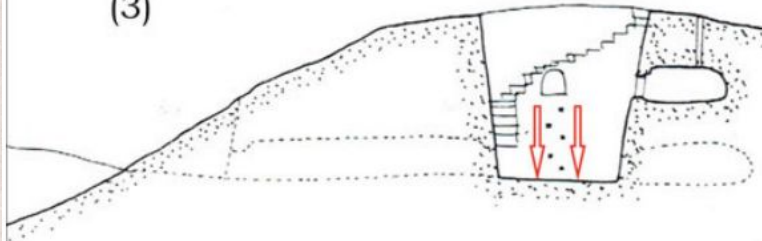

(6)

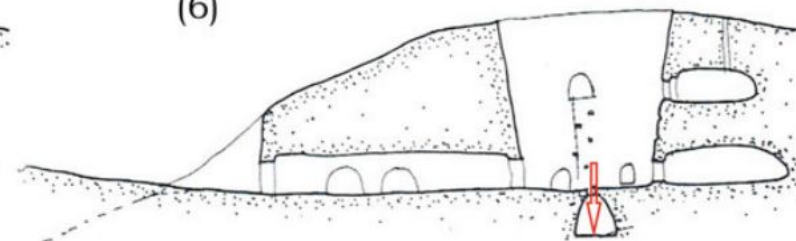

Design - conceptual bubble diagram

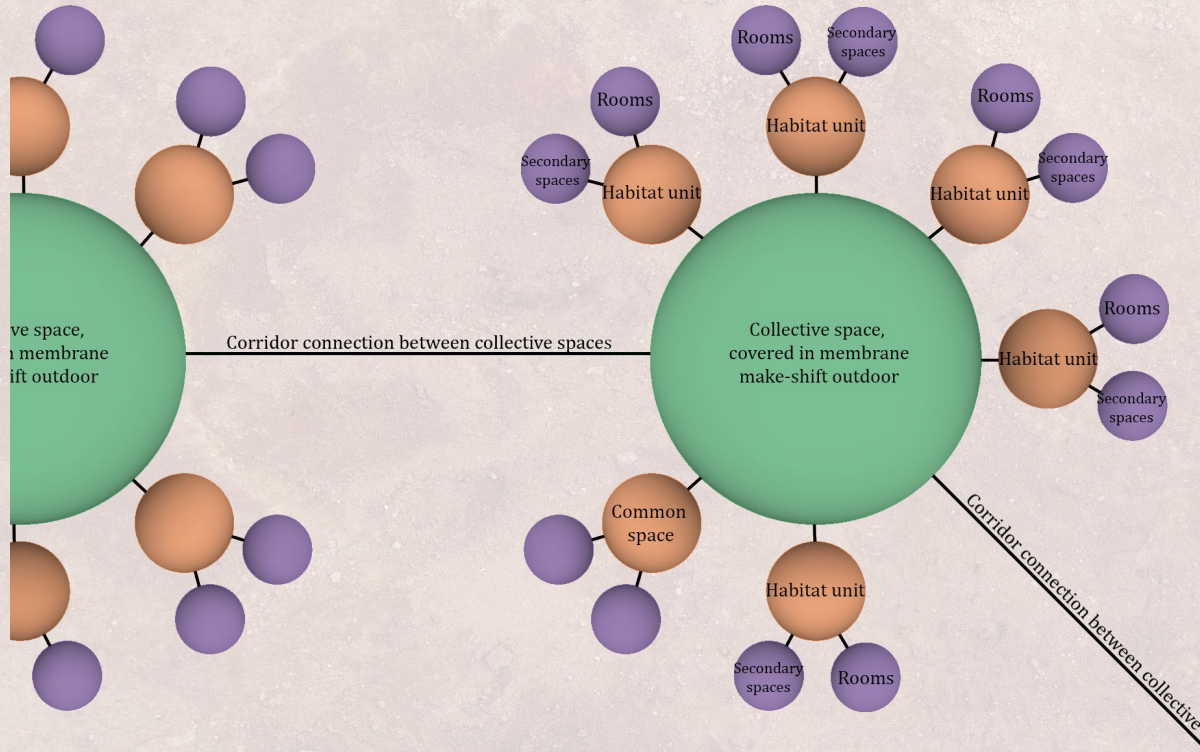

Case study - customization of spaces

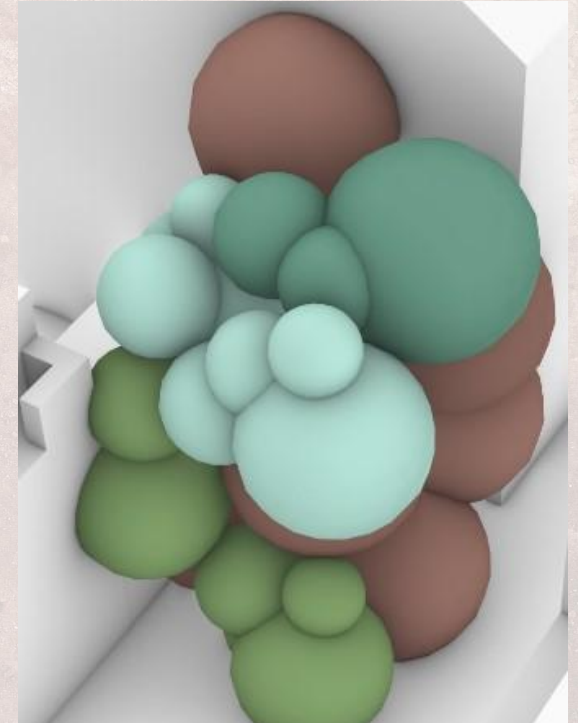
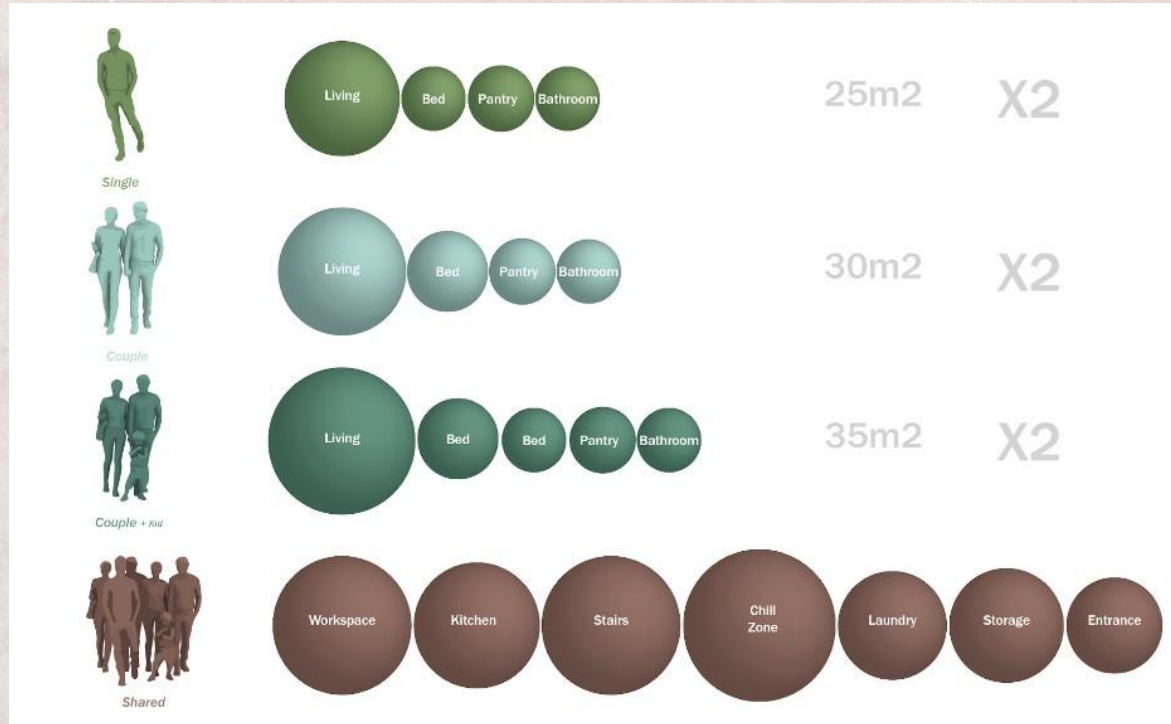

Design strategy - customization of volume

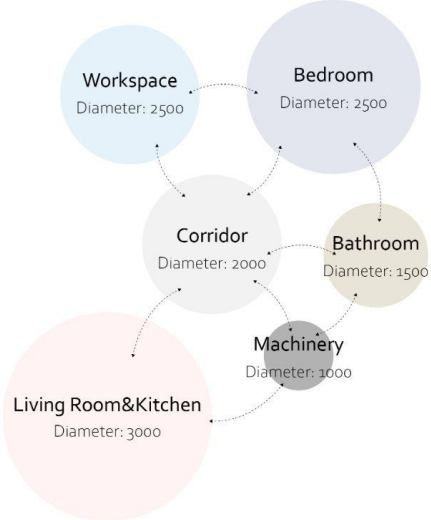
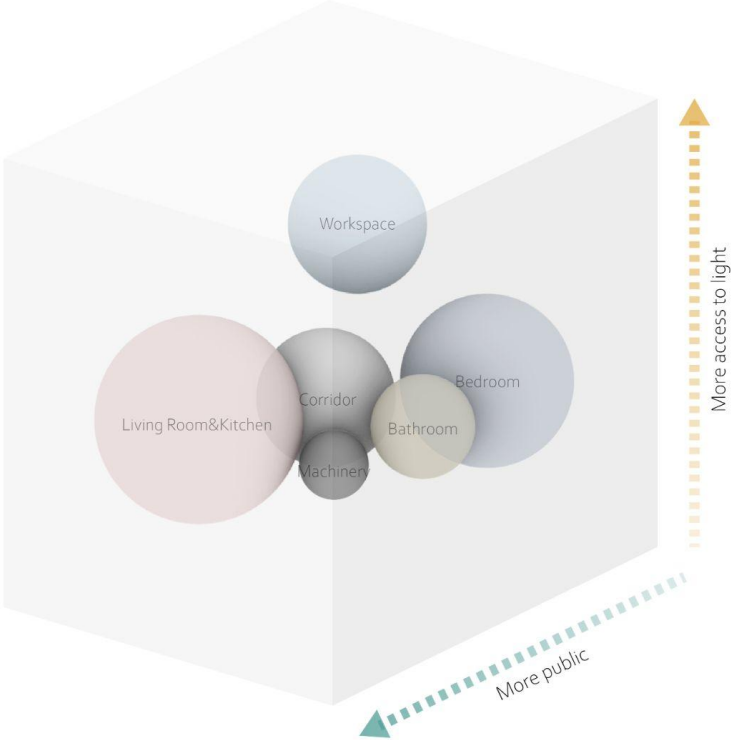

Translation of volume to voronoi

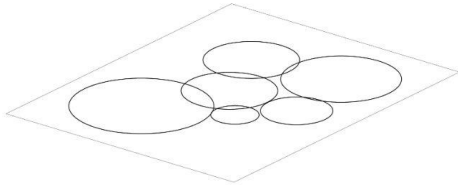
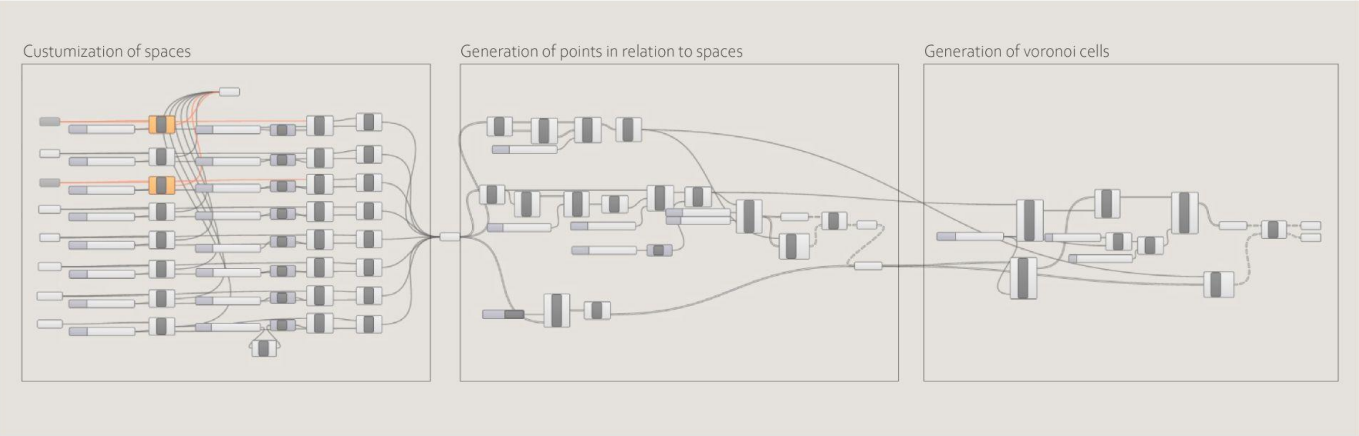

Zoning of spaces



Volumetric arrangement

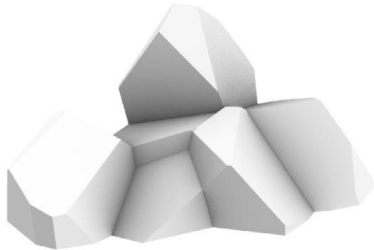

Voronoi generation



Selection of better options

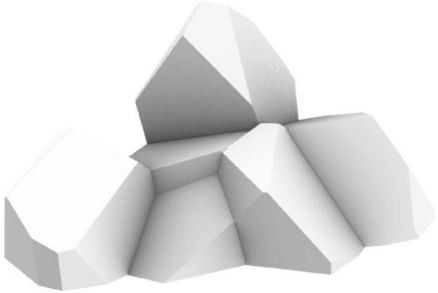

Voronoi overview

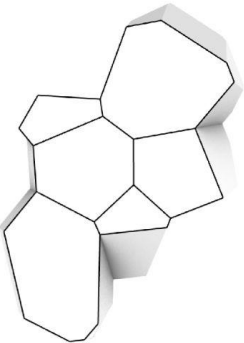

plan

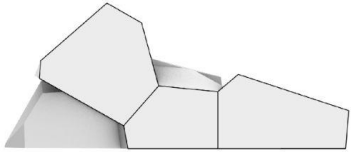

section

Voronoi housings to community

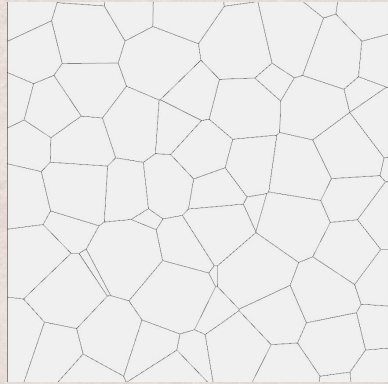

Voronoi cell construction

+

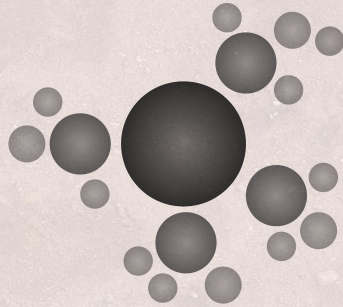

Programme organization

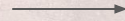

Voronoi cell organization

Option1

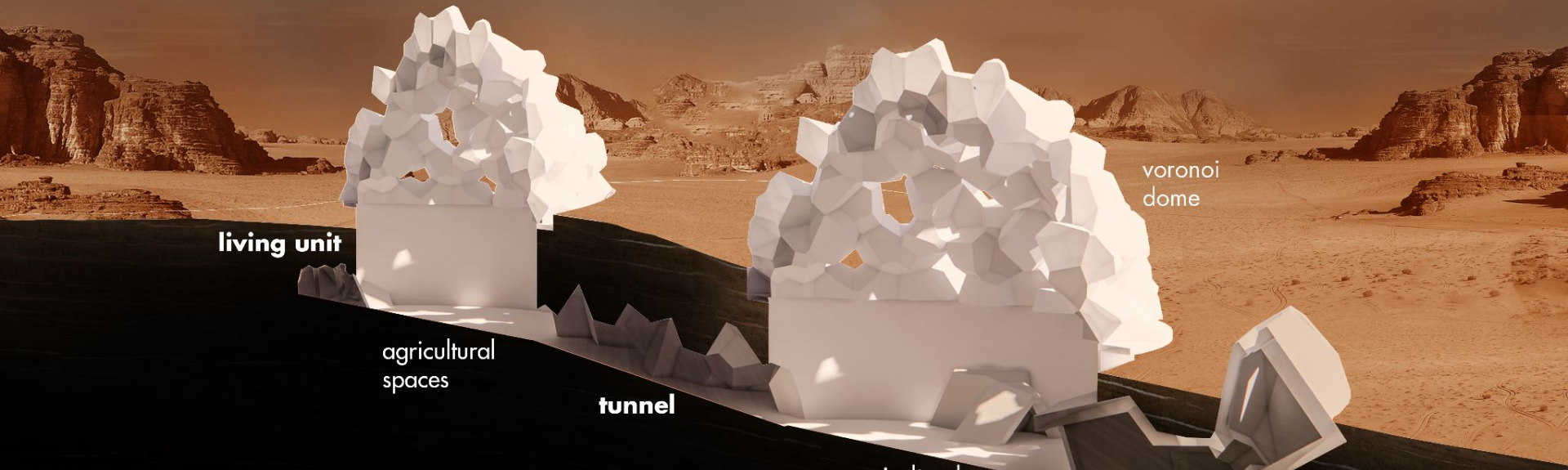

living unit

agricultural
spaces

tunnel

voronoi
dome

Option2

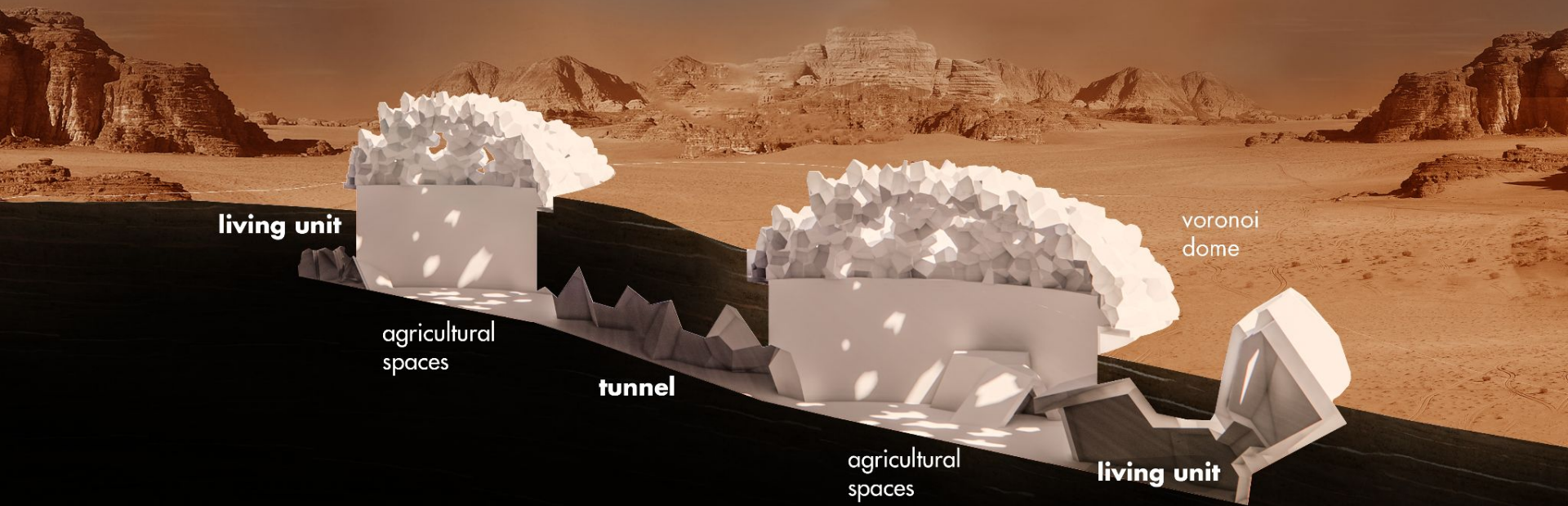

living unit

agricultural spaces

tunnel

agricultural spaces

living unit

voronoi dome

Option3



Interconnected communities



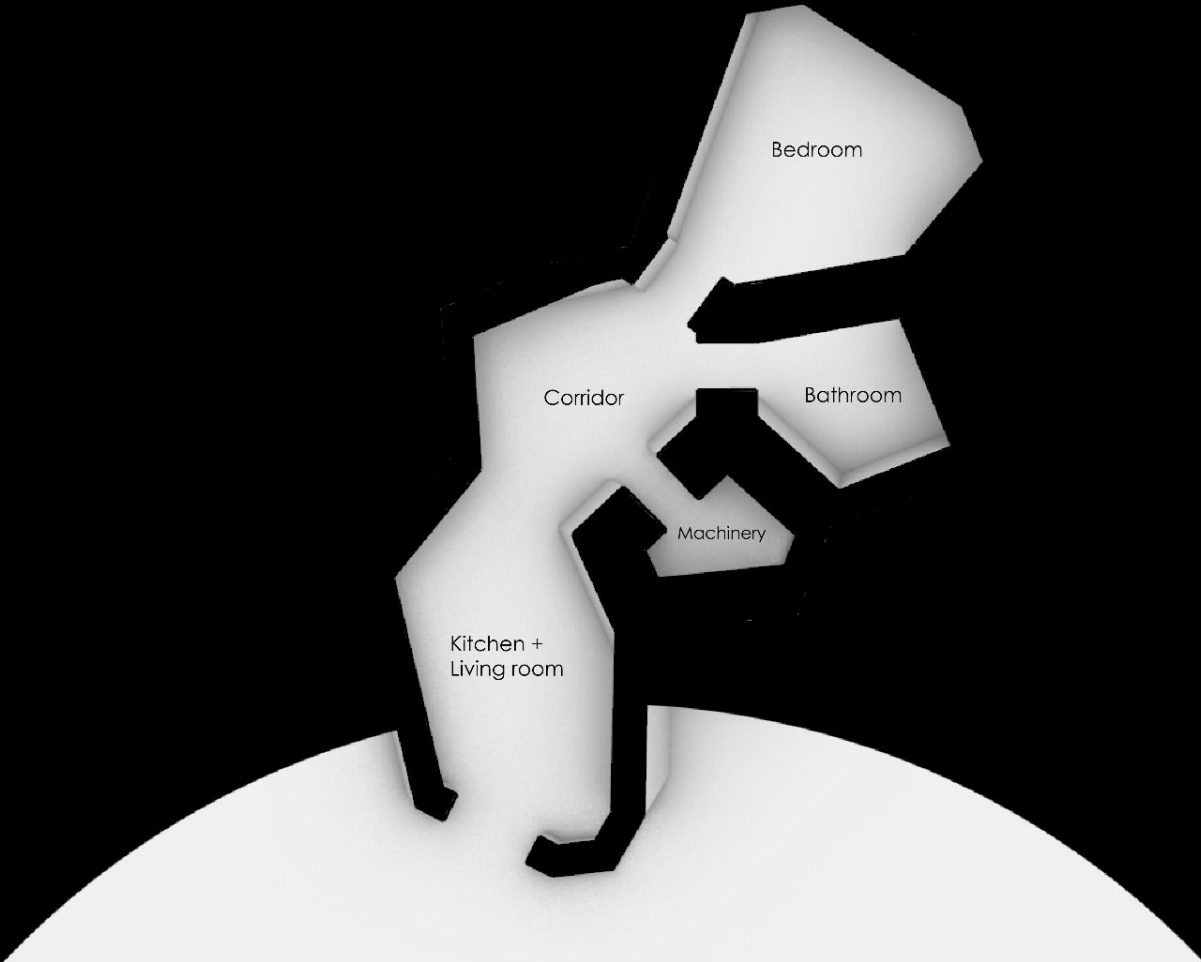

Bedroom

Bathroom

Machinery

Corridor

Kitchen +
Living room

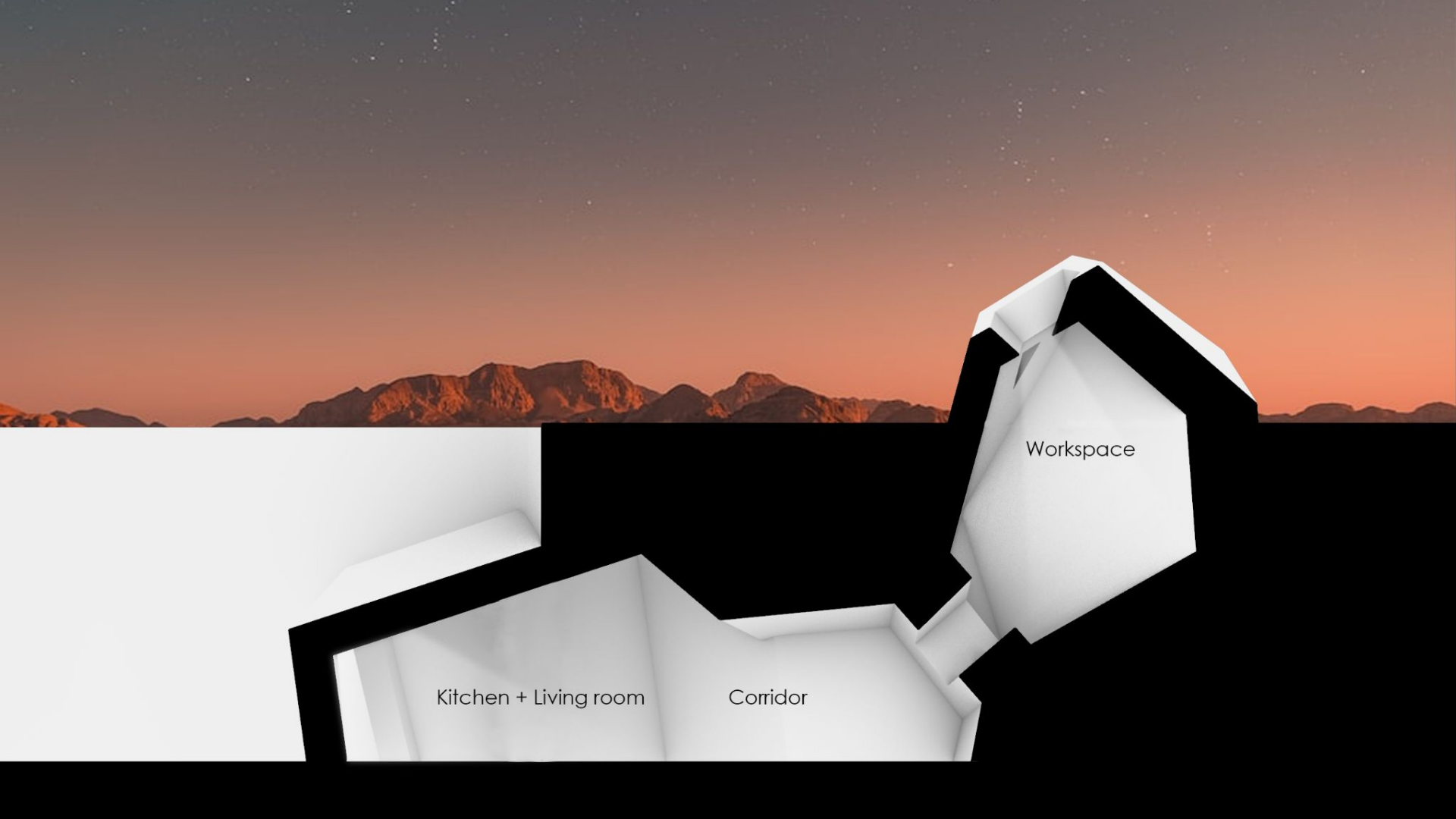

Workspace

Kitchen + Living room

Corridor

Furniture scale voronoi idea

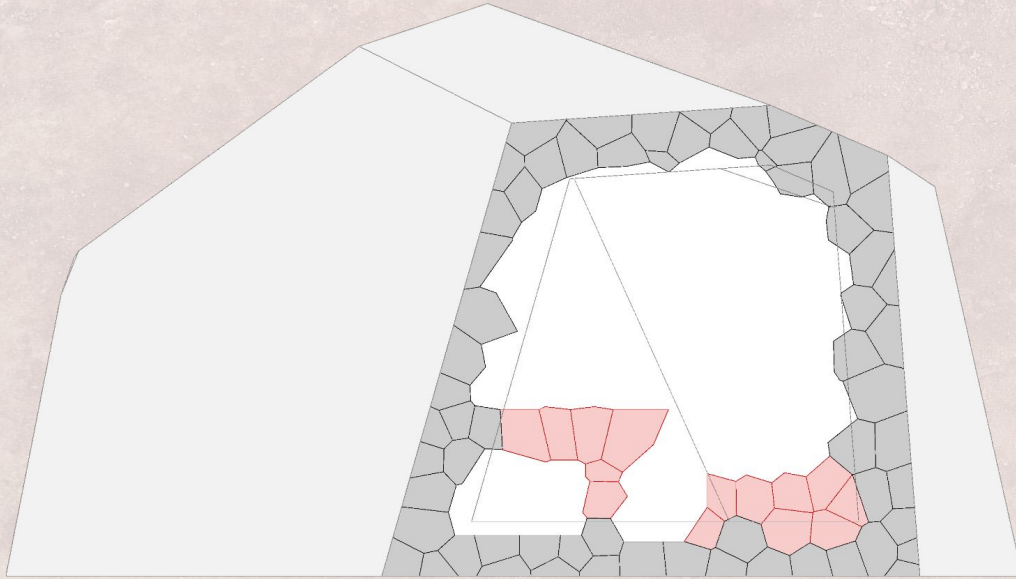

Initial bounding box, here represented in m2



Bounding
box

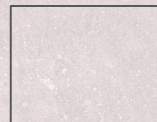
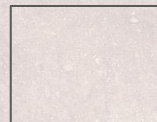
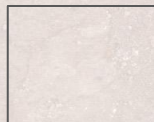
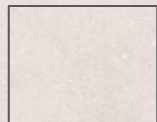

Creating vornoi3D

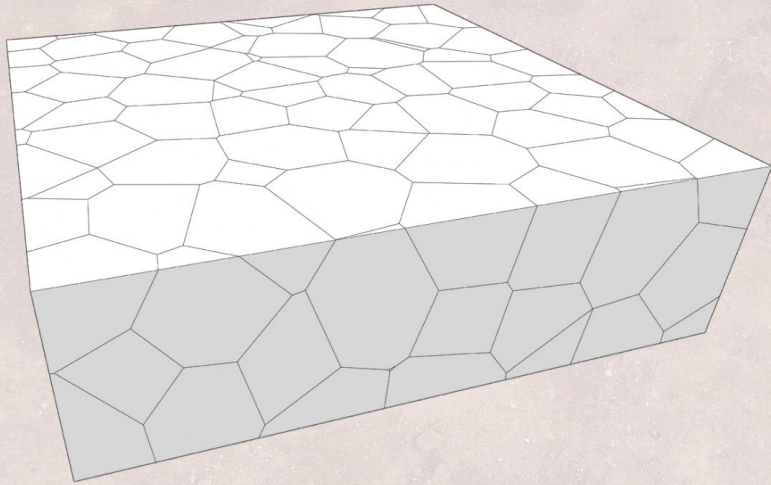

Bounding
box

Vornoi 3D



Removing vornoi cells that conflict with other spaces (a central open area in this case)

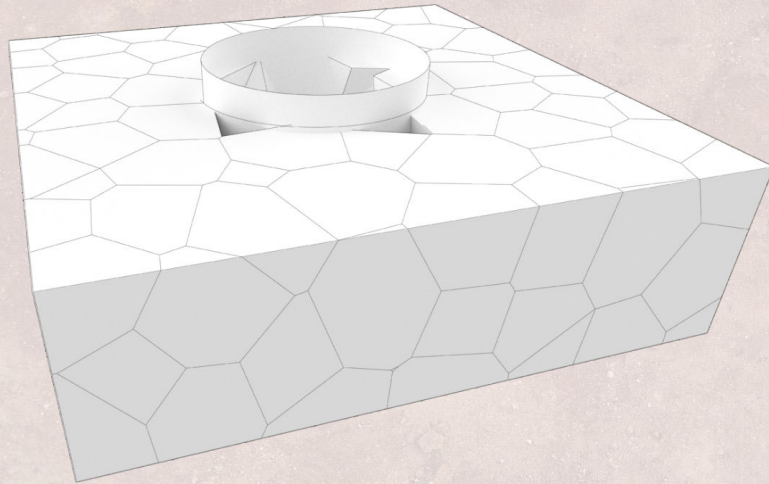

Bounding
box

Vornoi 3D

Remove
conflicting
cells



Hand selection of vornoi cells on a building scale

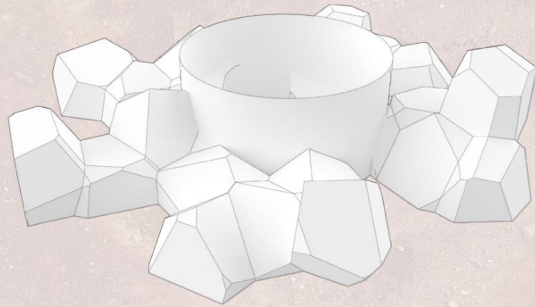

Bounding
box

Vornoi 3D

Remove
conflicting
cells

Selecting
cells to
keep



Selection of unit for further work

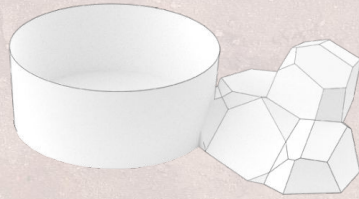

Bounding
box

Vornoi 3D

Remove
conflicting
cells

Selecting
cells to
keep

Choosing
housing
unit

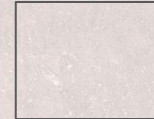
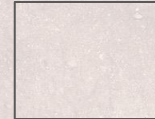

Selection of unit sub-space for further work



Bounding
box

Vornoi 3D

Remove
conflicting
cells

Selecting
cells to
keep

Choosing
housing
unit

choosing
sub-cell

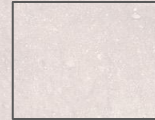

Shell the object to create wall thickness



Bounding
box

Vornoi 3D

Remove
conflicting
cells

Selecting
cells to
keep

Choosing
housing
unit

choosing
sub-cell

Shelling



Select fragment of wall for further work

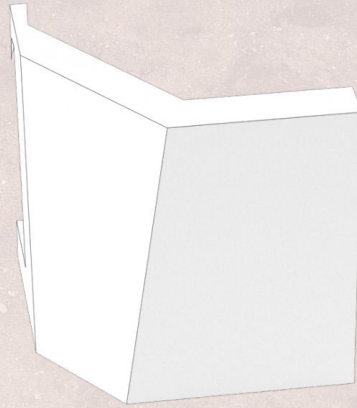
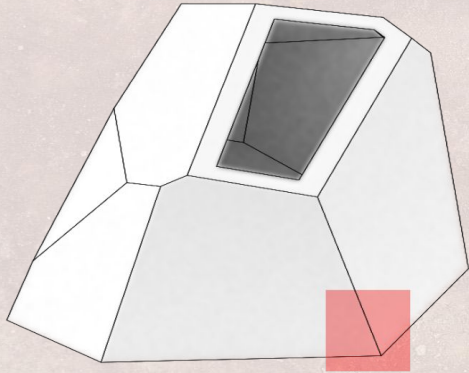

Bounding
box

Vornoi 3D

Remove
conflicting
cells

Selecting
cells to
keep

Choosing
housing
unit

choosing
sub-cell

Shelling

Selecting
fragment



Breaking the wall into smaller vornoi shapes

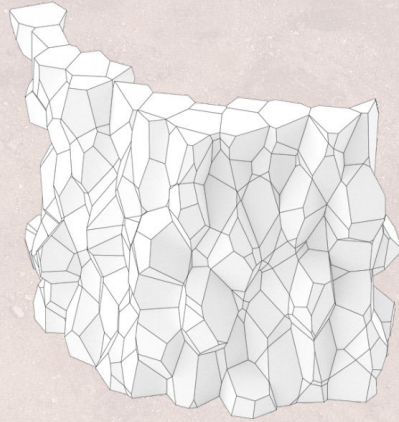

Bounding
box

Vornoi 3D

Remove
conflicting
cells

Selecting
cells to
keep

Choosing
housing
unit

choosing
sub-cell

Shelling

Selecting
fragment

Fragment
scale
vornoi



Hand selection of cells for components

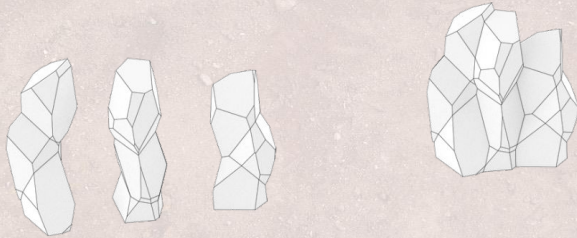

Bounding
box

Vornoi 3D

Remove
conflicting
cells

Selecting
cells to
keep

Choosing
housing
unit

choosing
sub-cell

Shelling

Selecting
fragment

Fragment
scale
vornoi

selecting
component
cells

Preparing the components for initial material removal toolpath creation

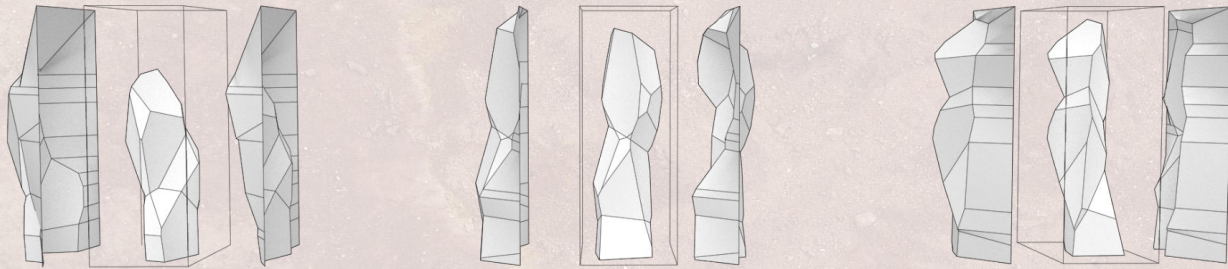

Toolpath creation, one for each side

