

MARS HABITAT AR122 1:1 INTERACTIVE ARCHITECTURE PROTOTYPES

Arno Decorte
Augusta Fiseryte
Tom Punte



Distance from Sun: 227.9 million km
Orbital period: 687 days
Gravity: 3.721 m/s²
Radius: 3,389.5 km
Surface area: 144.8 million km²
Length of day: 1d 0h 37m

Mars is the fourth planet from the Sun – a dusty, cold, desert world with a very thin atmosphere. Mars is also a dynamic planet with seasons, polar ice caps, canyons, extinct volcanoes, and evidence that it was even more active in the past.

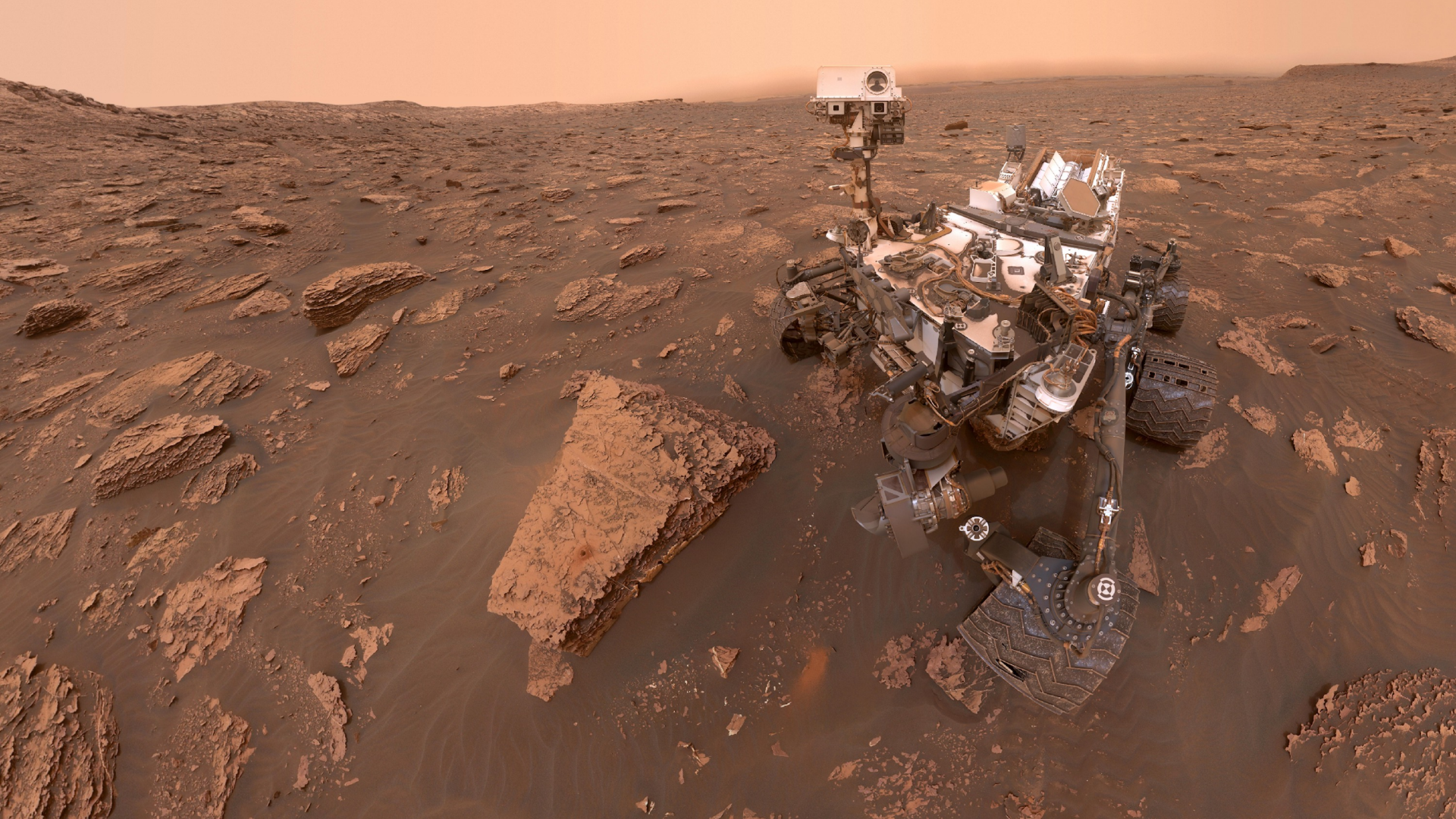

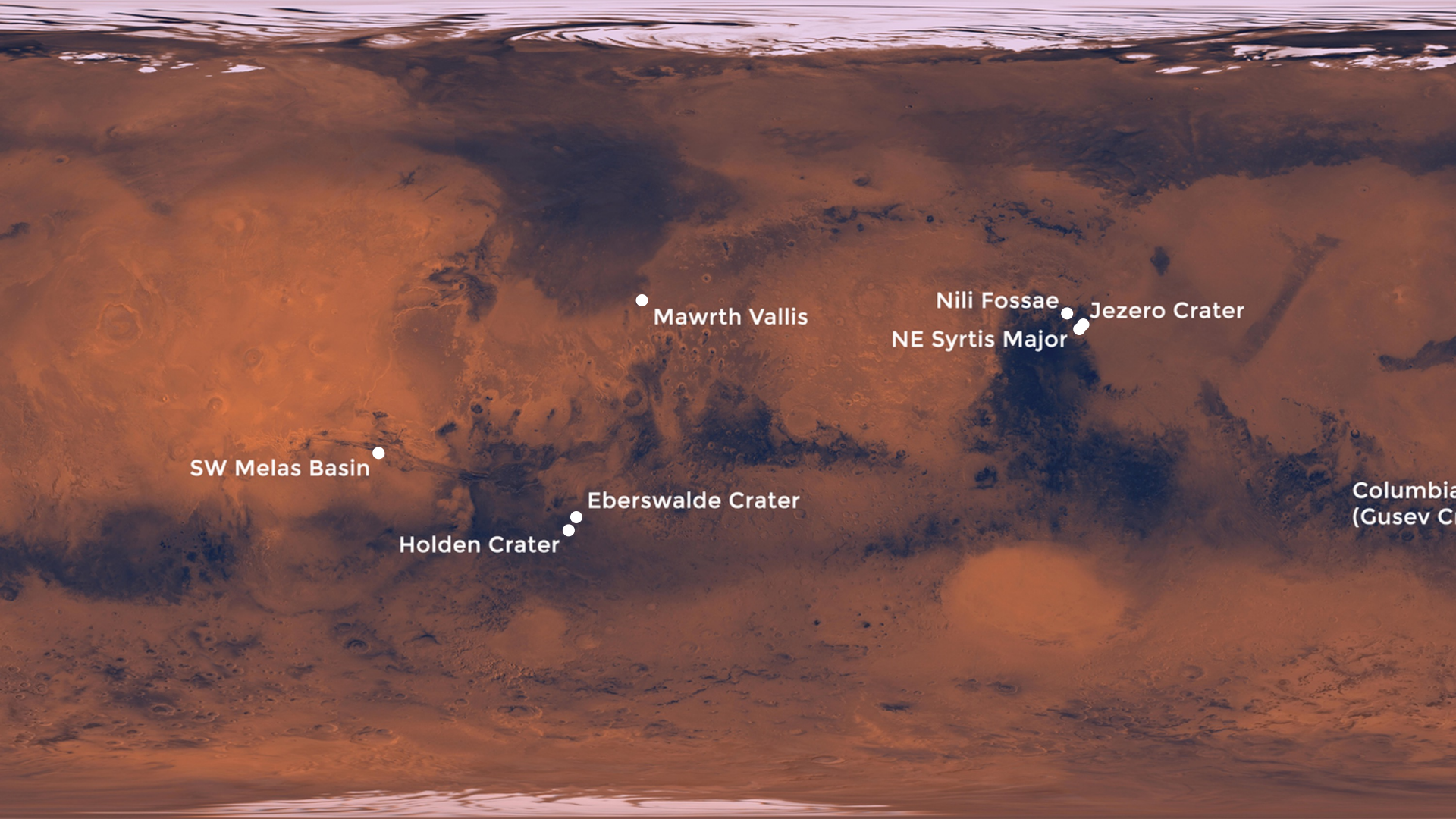

SW Melas Basin

Holden Crater

Eberswalde Crater

Mawrth Vallis

Nili Fossae
NE Syrtis Major

Jezero Crater

Columbia
(Gusev C)

WATER RESEARCH STATIONS FOR SCIENTIST WHO ARE
ANALYSING WATER ON MARS

PROGRAM
WATER RESEARCH
STATION

LIVING SPACES:

15M2 Sleeping quarters (3-4 people), with sleeping pods
(with beds, work desk and enclosure)
5M2 Sanitation space
20M2 Living quarters and kitchen
10M2 Workout/recreation space

WORKSPACES:

20-30M2 Laboratory

OTHER:

10M2 Storage space
5M2 Life-support systems
Solar storm shelter, combine with living spaces

Entrance and exit
Garden

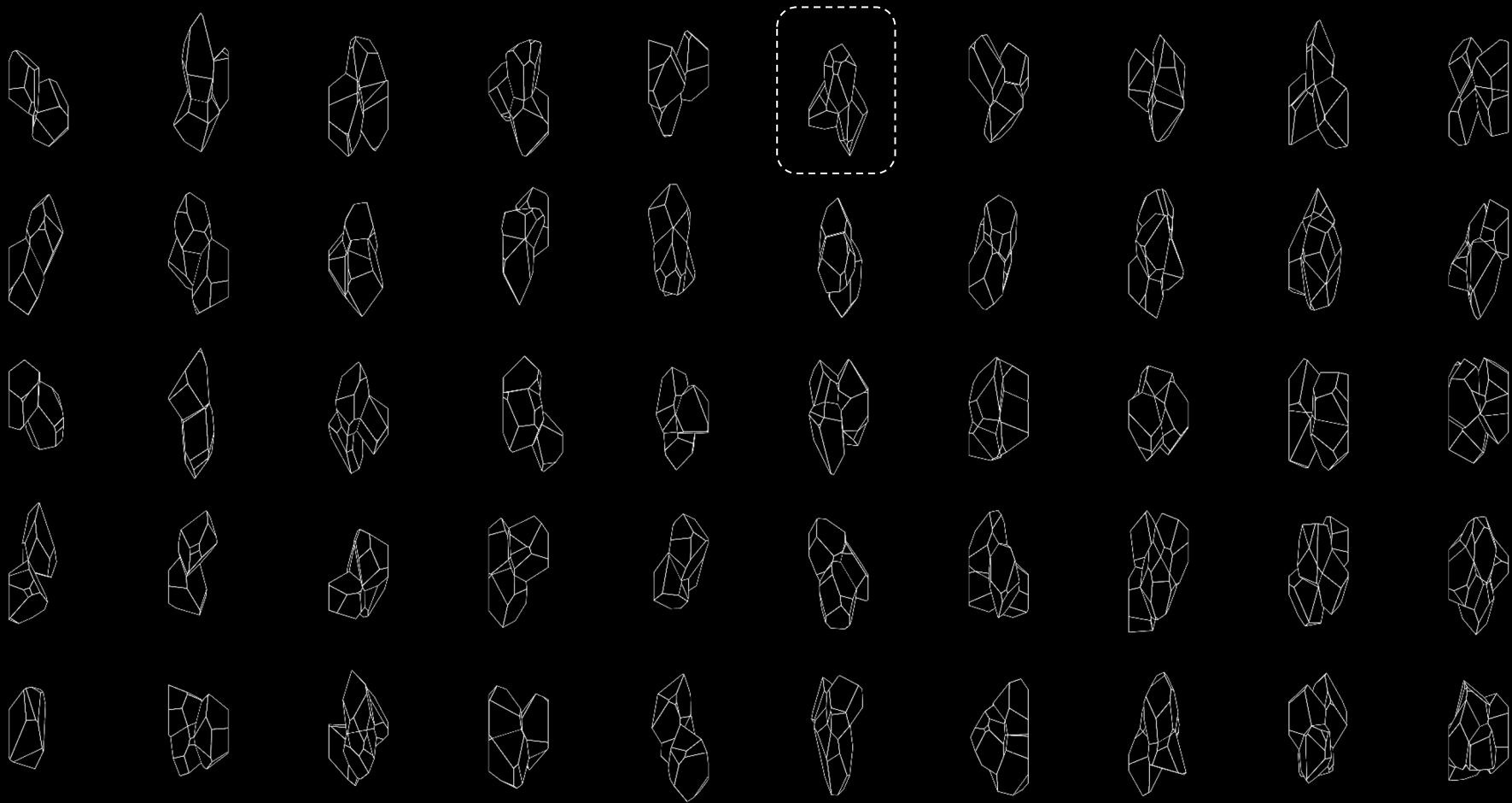

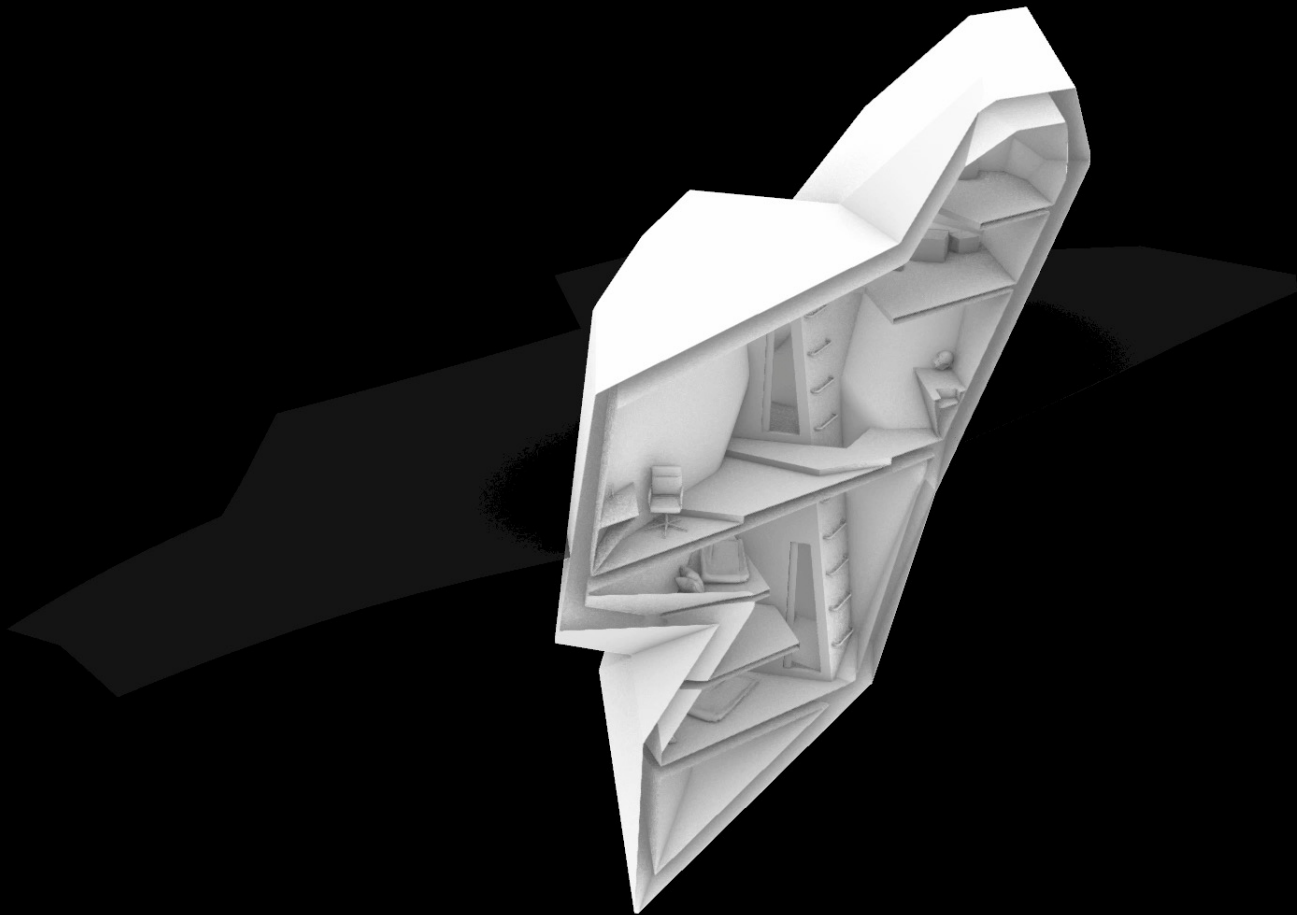

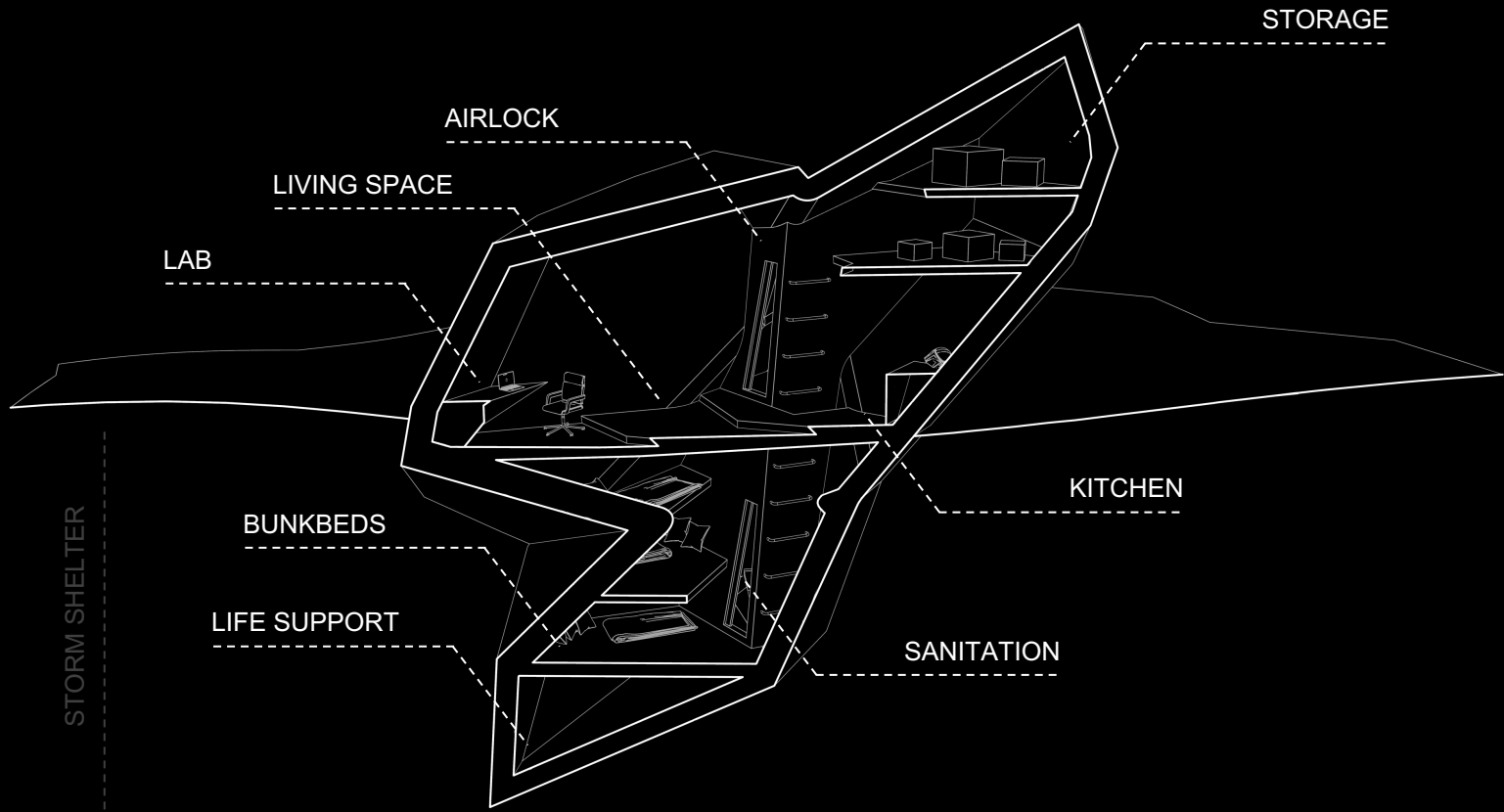

STORAGE

AIRLOCK

LIVING SPACE

LAB

KITCHEN

SANITATION

BUNKBEDS

LIFE SUPPORT

STORM SHELTER

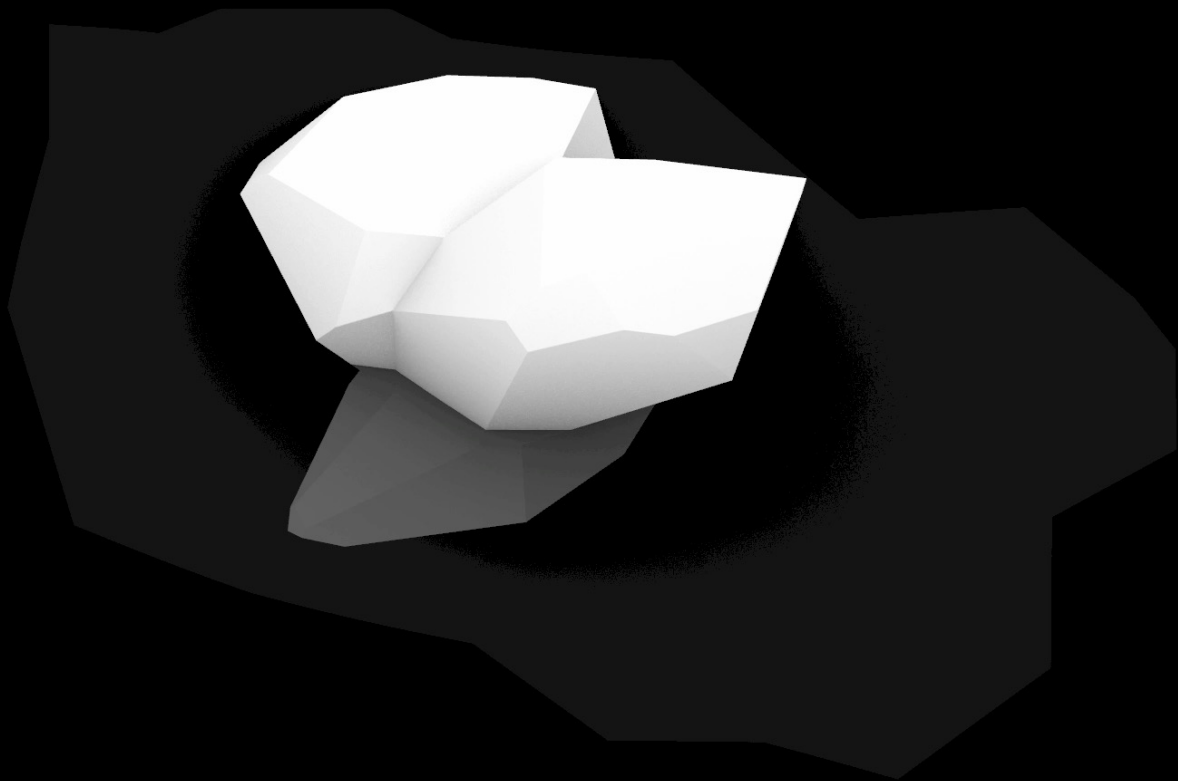





ASSEMBLY
UNGROUND PART

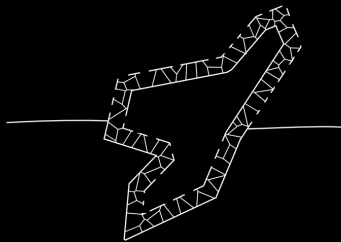

ASSEMBLY ABOVE
PART

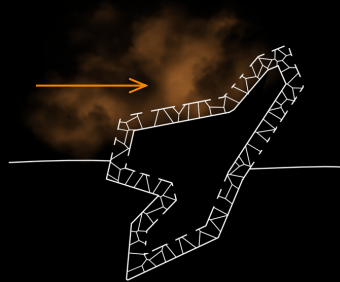

SAND STORMS
APPEAR

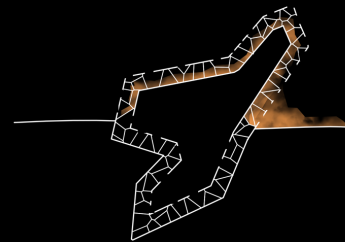

CAVERN STRUCTURE
FILLS UP WITH SAND

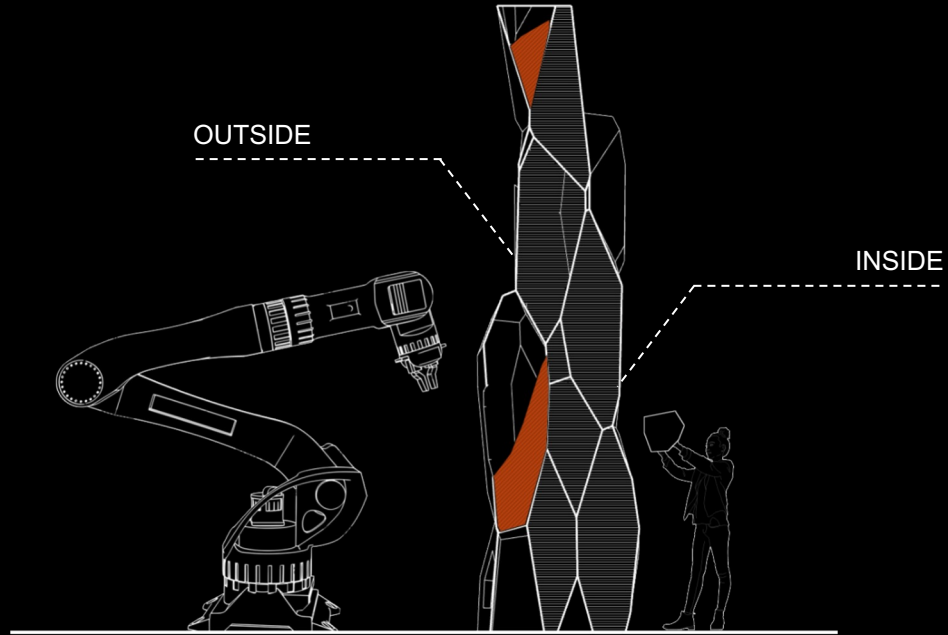

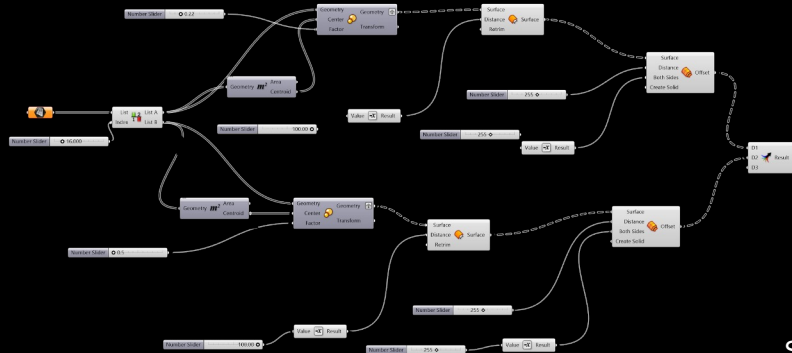

ROBOT HANDLE

HUMAN HANDLE

SAND CAVERN

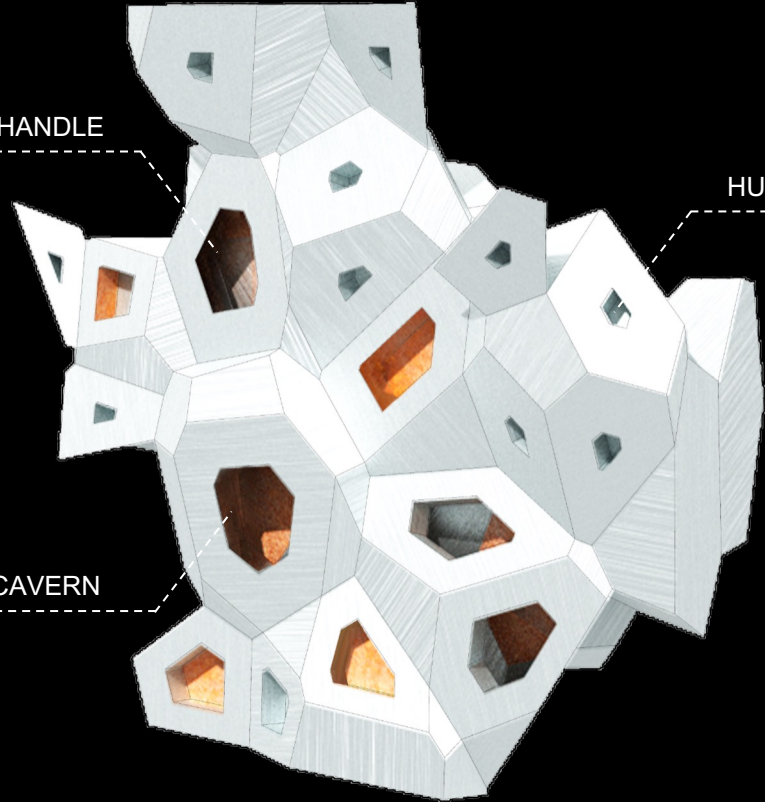

ADDITIONAL RESEARCH

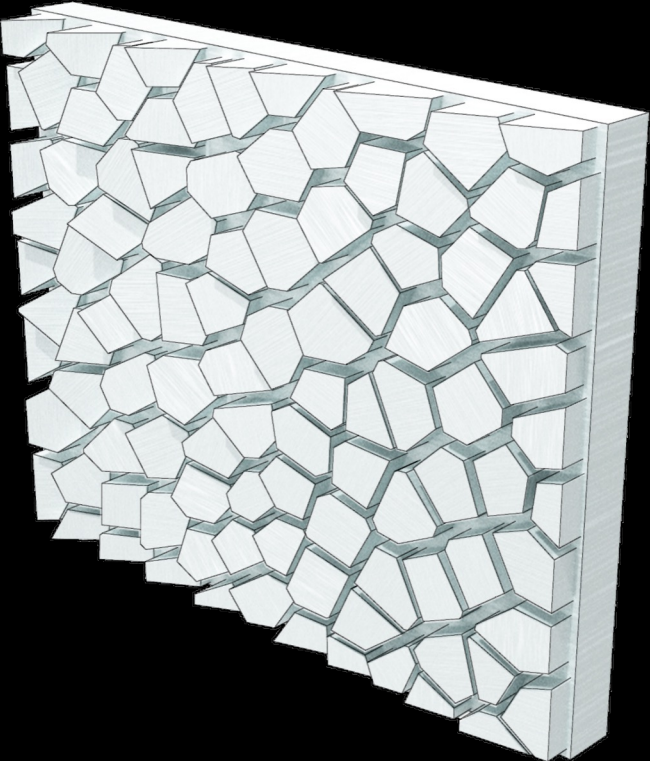
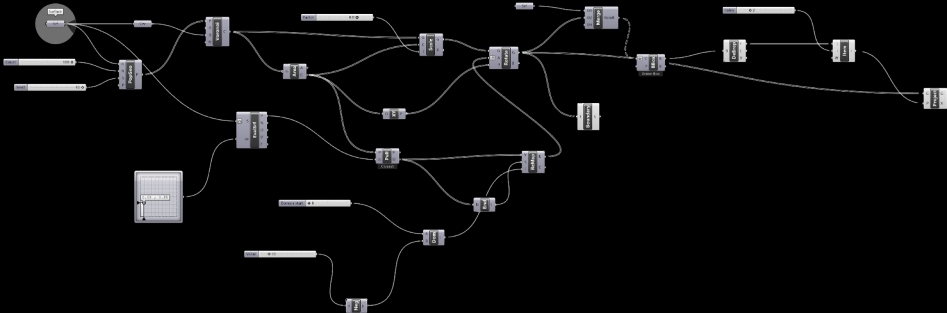

WIND DIRECTION

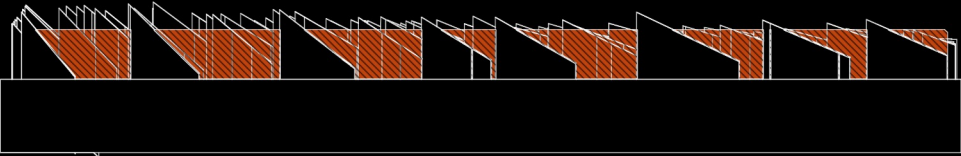

70° ----- 35°

